



- Horn: Omnidirectional/max. 100 dB(A)
- Type of protection: Ex d
- Class: IP 66 (IEC 60529/NEMA 4X)
- Corrosion-resistant aluminium enclosure
- Stainless steel mounting and console sealing element included
- Prewiring preconfigured
- 32 standardised preconfigured signal sounds (PFEER/UKOOA compatible)
- Low installation height (29 mm)
- Low weight (1.5 kg)

E5

WebCode YA11A



Product series YA 11 is designed to provide an audible signal and is intended for use in hazardous areas or the harshest environments.

	IECEX / ATEX						NEC 500 CEC Appendix J					
	0	1	2	20	21	22	Class I		Class II		Class III	
Zone							1	2	1	2	1	2
Installation in			•			•		•				

Selection Table

Tone selection	According to the order		
Certificates	ATEX (BAS), Canada / USA (UL), IECEx (BAS)		
Rated operational voltage DC	Product Type	Art. No.	Weight kg
24 V	YA11/1-D-...-RN	211439	1.500

Technical Data

Explosion Protection	
Ambient temperature °C	-40 ... +70 °C
IECEX gas explosion protection	Ex nA IIC T4 Gc
IECEX dust explosion protection	Ex tc IIIC T90 °C Dc
ATEX gas explosion protection	⊕ II 3 G Ex nA IIC T4 Gc
ATEX dust explosion protection	⊕ II 3 D Ex tc IIIC T90 °C Dc
Acoustic Data	
Sound pressure level	max. 100 dB(A) @ 1 m
Number of stages	1
Mechanical Data	
Enclosure material	Aluminium / ABS
Enclosure colour	Red (RAL 3001)
Degree of protection IP (IEC 60529)	IP66
Conductor length	3 m
Mounting / Installation	
Material mounting parts	Stainless steel
Connection type	ÖLFLEX150 QUATTRO/18AWG 2x1mm ²

You can find more technical data online at r-stahl.com. WebCode YA11A

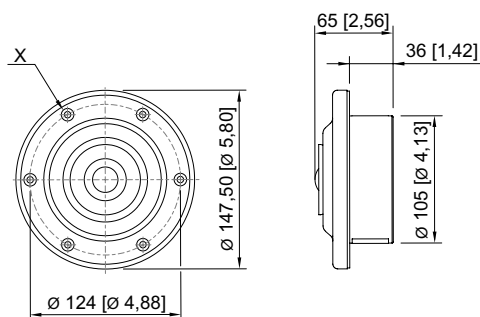

Tone Table

Tone no.	Version	Frequency	Repetition rate (sec)	Special application
Tone 01	Alternate two-tone	800-1000	0.5	Fire alarms - Level crossing
Tone 02	Alternate two-tone	2500-3100	0.5	Security alarms
Tone 03	Alternate fast two-tone	800-1000	0.25	Increased urgency - Level crossing
Tone 04	Alternate fast two-tone	2500-3100	0.25	Security deterrent
Tone 05	Alternate two-tone	440-554	0.4/0.1	AFNOR, France
Tone 06	Alternate two-tone	430-470	1.0	
Tone 07	Alternate fast two-tone	800-1000	0.13	
Tone 08	Alternate fast two-tone	2500-3200	0.07	
Tone 09	Alternate two-tone	440-554	2.0	Turn out, Sweden
Tone 10	Continuous tone	700		All-clear, Sweden
Tone 11	Continuous tone	1000		
Tone 12	Continuous tone	1000		
Tone 13	Continuous tone	2300		
Tone 14	Continuous tone	440		
Tone 15	Interrupted tone	1000	2.0	
Tone 16	Interrupted tone	420	1.25	AS2220, Australia
Tone 17	Interrupted tone	1000	0.5	
Tone 18	Interrupted tone	2500	0.25	
Tone 19	Interrupted tone	2500	0.5	
Tone 20	Interrupted tone	700	6/12	Pre-vital message, Sweden
Tone 21	Interrupted tone	1000	1.0	
Tone 22	Interrupted tone	700	4.0	Air-raid alarm, Sweden
Tone 23	Interrupted tone	700	0.25	Local warning, Sweden
Tone 24	Interrupted tone	720	0.7/0.3	Industrial alarm, Germany
Tone 25	Interrupted, fast, rising volume	1400	0.25	
Tone 26	Fast siren	250-1200	0.085	
Tone 27	Rising constant, fall	1000	10/40/10	Industrial alarm, Germany
Tone 28	ISO 8201 Evacuation	800-1000	As standard	International evacuation alarm
Tone 29	Fast whoop	500-1000	0.15	
Tone 30	Slow whoop	500-1200	4.5	Evacuation, The Netherlands
Tone 31	Reverse sweep	1200-500	1.0	Evacuation, Germany
Tone 32	Siren	500-1200	3.0	