

Emergency Luminaire with LED EXLUX

Series 6009/4

STAHL



- The latest LED technology with a high luminous efficacy and a long service life
- Extremely high luminaire efficacy
- Can be adjusted from a 1.5 to a 3.0 h rated operating time
- Luminous flux after 100,000 h still 90% of the starting luminous flux
- Optionally with DALI for controlling and monitoring the luminaire
- Weekly functional test and annual rated operating time test

WebCode 6009D



The emergency luminaire with Series 6009/4 LED with integrated battery can be installed in stand-by switching, continuous mode or in switchable stand-by switching. A weekly functional test and annual rated operating time test are performed automatically. The results are indicated by an LED.

	ATEX / IECEx					
Zone	0	1	2	20	21	22
Installation in		•	•		•	•

Selection Table						
Design size	2					
Lamp wattage	25 W					
Luminaire efficacy	116 lm/W					
Luminous flux	2910 lm					
Drilled holes	Threaded plate	Cable entries	Stopping plug	Product Type	Art. No.	
3 x M20	2x SS430 stainless steel	Can be ordered as accessories	Can be ordered as accessories	6009/4128-2103-162-2220-22-850011	267868	
3 x M25	2x plastic	2 x M25 Ø 7 – 17 mm	2 x M25 x 1.5	6009/4128-2103-162-1110-11-850011	267867	
Design size	4					
Lamp wattage	45 W					
Luminaire efficacy	129 lm/W					
Luminous flux	5810 lm					
Drilled holes	Threaded plate	Cable entries	Stopping plug	Product Type	Art. No.	
3 x M20	2x SS430 stainless steel	Can be ordered as accessories	Can be ordered as accessories	6009/4148-2103-162-2220-22-850011	267875	
3 x M25	2x plastic	2 x M25 Ø 7 – 17 mm	2 x M25 x 1.5	6009/4148-2103-162-1110-11-850011	267872	

Cable entries and stopping plugs made from moulded material are included loose with the product (installation required).
Threaded plate included.

The light fittings are supplied without mounting material.





Technical Data	
Explosion Protection	
IECEx gas explosion protection	Ex db eb ib mb op is IIC T4 Gb
IECEx dust explosion protection	Ex tb op is IIIC T100 °C Db
ATEX gas explosion protection	Ⓔ II 2 G Ex db eb ib mb op is IIC T4 Gb
ATEX dust explosion protection	Ⓔ II 2 D Ex tb op is IIIC T100 °C Db

Technical Data

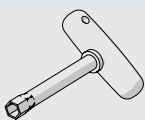
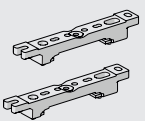
Explosion Protection	
Ambient temperature °C	-30 ... +50 °C
Note: Through wiring	max. 3x16 A
Ambient temperature °C 2	-30 ... +55 °C
Note: Through wiring 2	max. 3x10 A
Certificates	ATEX (IBE), IECEx (IBE)
Electrical Data	
Rated operational voltage AC	110 – 240 V
Battery operating voltage	6 V
Battery capacity	7 Ah
Frequency range	50 – 60 Hz
Battery version	NiCd battery, gas-tight
Lighting Data	
Number of lamps	1
Lamp	LED
Light colour	Neutral white
Light distribution	120°x120° with diffusing glass
Operating time	1.5 / 3h emergency lighting operation
Colour rendering	≥ 80
Colour temperature	5000 K
Mechanical Data	
Enclosure material	Polyester resin, Glass fibre reinforced
Diffuser	With diffuser
Sealing material	Silicone
Installed terminal strip	PE + N + L1 + L2 + L3 + L´
Connection terminals solid max.	6 mm ²
Connection terminals finely-stranded max.	4 mm ²
Type of connection cable	Finely stranded Solid
Impact strength (IK code)	IK10 (IEC 62262)
Enclosure colour	Light grey (RAL 7035)
Notes	Connection terminals: Spring clamp terminal (2 free clamping units per pole)
Components	
Ballast	6046/211-121-010 LED NLE 7Ah
Through wiring	With 6 conductors 2.5 mm ²
Material cable gland	Polyamide, black
Stopping plug material	Polyamide, black

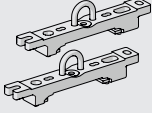
Accessories

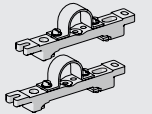
Figure	Description	Art. No.	Weight kg
Socket key			
	M8 / wrench size 13; to open/close the central locking	222430 ▲	0.110
Mounting rail			
	for a variable mounting distance; 1 pair	222826 ▲	0.350

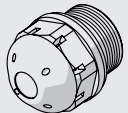
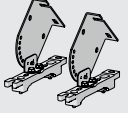
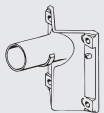
Accessories			
Figure	Description	Art. No.	Weight kg
Mounting bracket			
	mounting clamp mounted on a mounting rail for a variable mounting distance; 1 pair	222456 ▲	0.400
Pole mounting sleeve			
	for the subsequent mounting on lights size 2 and size 4, completely with assembly parts (for pipe diameter 42 mm)	227512	3.200
Pipe clamp			
	R 1 1/2"; with mounting rail for a variable mounting distance; Material: stainless steel; 1 pair	222459 ▲	0.800
	R 1 1/4"; with mounting rail for a variable mounting distance; Material: stainless steel; 1 pair	222458 ▲	0.700
	R 2"; with mounting rail for a variable mounting distance; Material: stainless steel; 1 pair	222460 ▲	0.750
Ring bolt			
	M8, direct mounting in insert nuts; 1 pair	115736 ▲	0.115
Breather			
	Thread: M25 x 1.5; 1 pc; for installation in lights; in moulded material; without counter nut	138573 ▲	0.010
	Thread: M25 x 1.5; 20 pc; for installation in lights; in moulded material; without counter nut	138576 ▲	0.200
	M25 x 1.5 in order to avoid condensate formation	115738 ▲	0.017
Ceiling and wall mounting bracket			
	mounted on a mounting rail for a variable mounting distance; Material: stainless steel; Lamp can be swiveled in steps of 15°; 1 pair	222827 ▲	1.200
Bracket for wall mounting with tube			
	for side entry lamp; with tube, length 400 mm, Ø 42 mm	108947 ▲	2.480

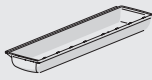
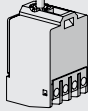
Spare Parts			
Figure	Description	Art. No.	Weight kg
Cover			
	for luminaire size 4 (resistant to aromatic substances)	256535	1.167
	for luminaire size 2 (resistant to aromatic substances)	256534	0.679
	for luminaire size 4	222428	1.149
	for luminaire size 2	222427	0.639
Contact element			
	8080/1-3-L 2 NC contact element	132527	0.026

Spare Parts

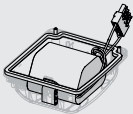
Figure	Description	Art. No.	Weight kg
	Battery cover with built-in battery. Gas-tight NiCd battery; 7 Ah / 6 V	223532	1.195

Dimensional Drawings (All Dimensions in mm [inches]) – Subject to Alterations

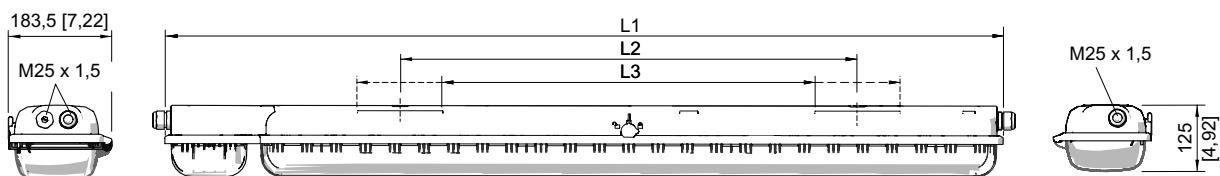

Size 2:
 L1 = 857 mm [33.74]
 L2 = 400 mm [15.75]
 L3 = 320 ... 480 mm [12.60 ... 18.90]

Size 4:
 L1 = 1467 mm [57.76]
 L2 = 800 mm [31.50]
 L3 = 670 ... 930 mm [26.38 ... 36.61]

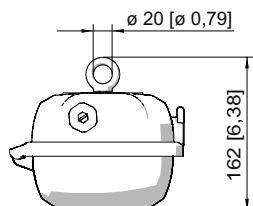

Ring bolt fitted in insert nut of the luminaire

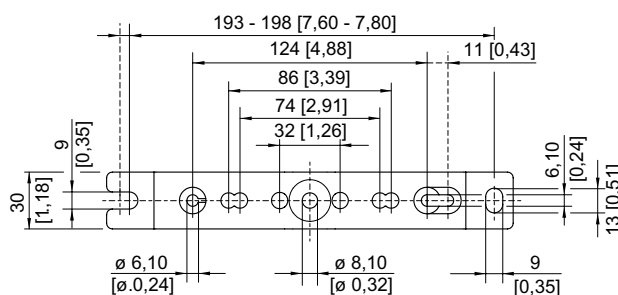
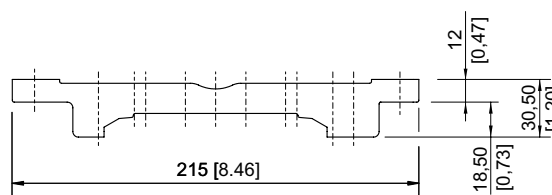

Mounting rail

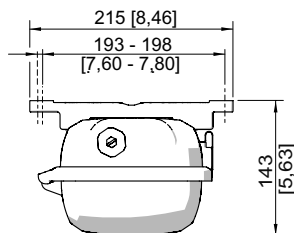

Mounting rail

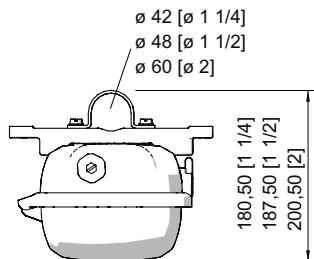

Pipe clamp fitted in mounting rail

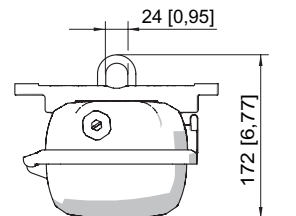

Mounting bracket fitted in mounting rail

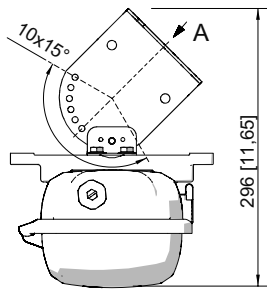

A

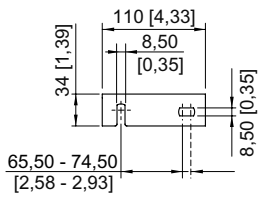

Wall mounting bracket fitted in mounting rail

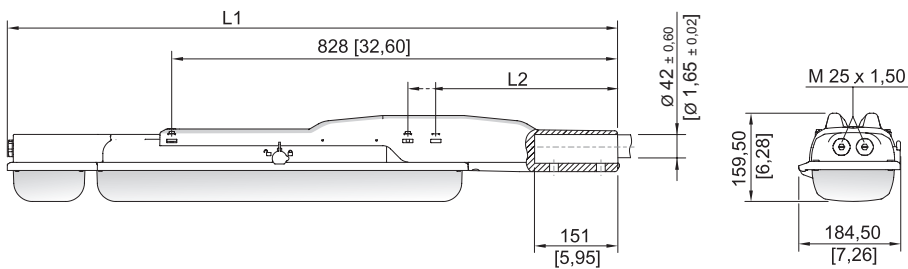

With pole mounting sleeve

Size 2:

L1 = 1133 mm [44.61]

L2 = 390 mm [15.35]

Size 4:

L1 = 1742 mm [68.58]

L2 = 338 mm [13.31]